

# BLOCK F + G

Sheet 02

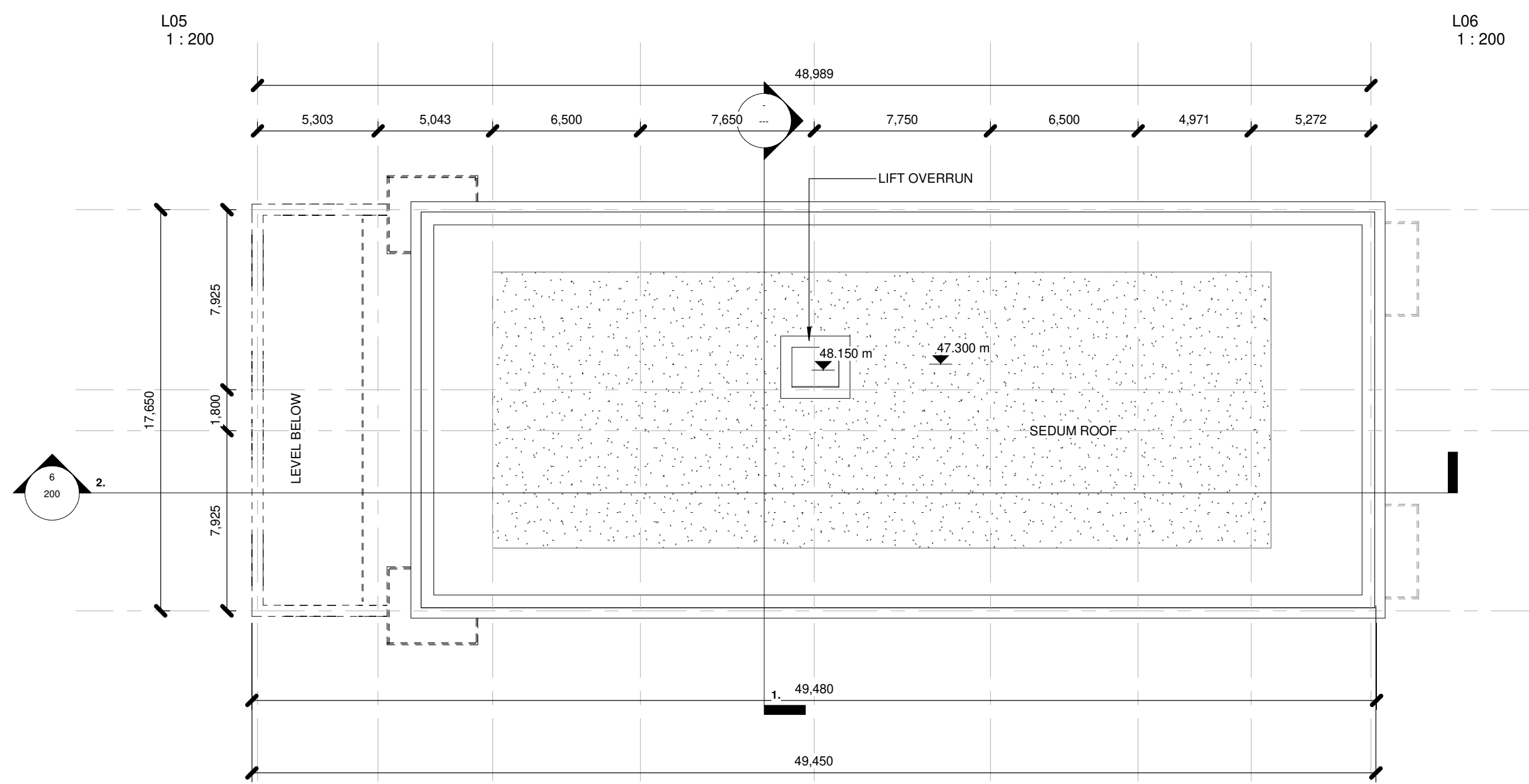
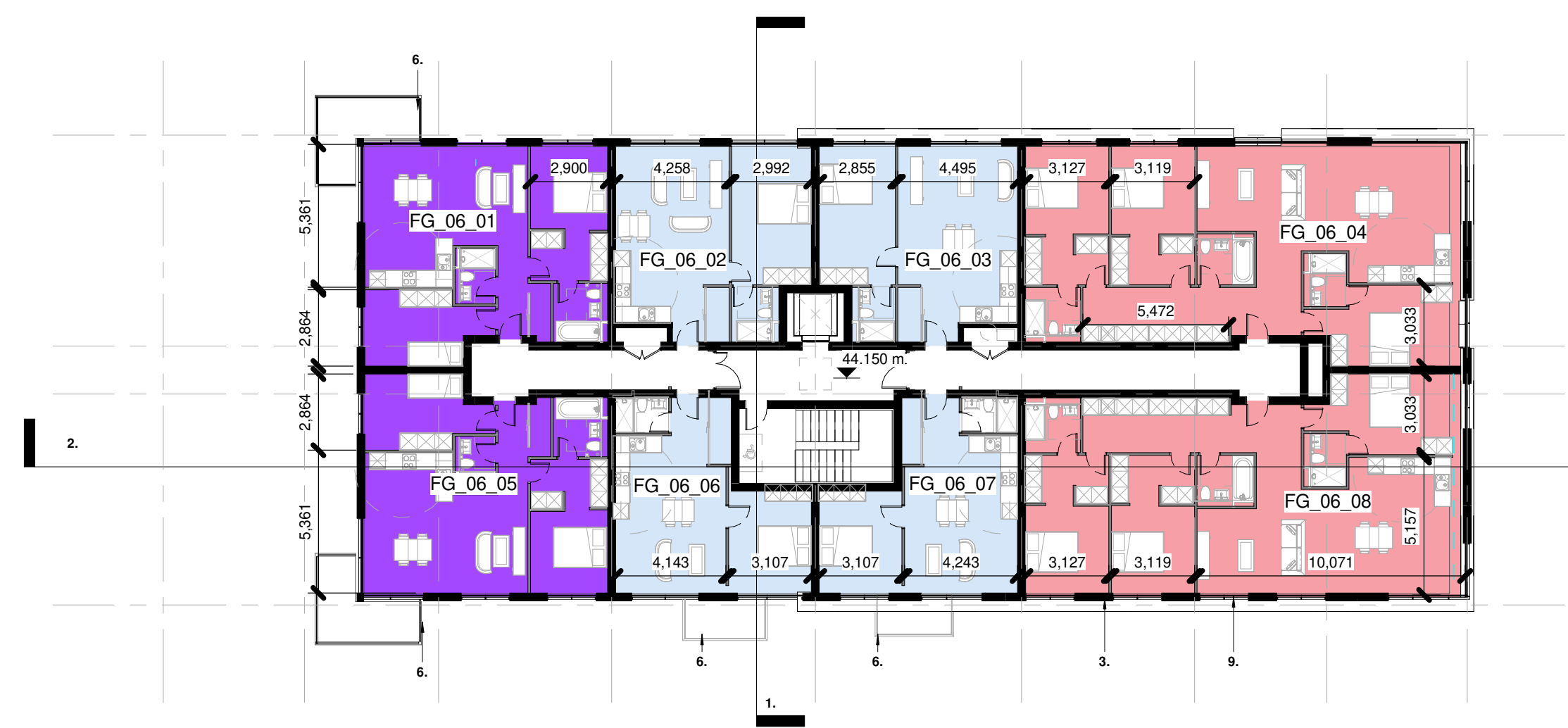

**Notes:**  
 - Do not scale from this drawing. Use figured dimensions in all cases.  
 - Verify dimensions on site and report any discrepancies to the Architect immediately.  
 - This drawing is to be read in conjunction with the Architect's Specification.  
 - © This drawing is copyright and may only be reproduced with the Architect's permission.

**Drawing Notes:**

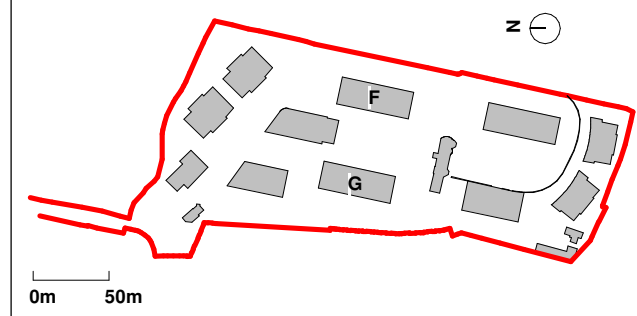

- Indicates Site Boundary
- Site Area within Boundary = 35,767.1 m<sup>2</sup>
- Indicates Adjacent Site in Ownership of Applicant
- ▲ Site Access
- ▲ Building Access

- Apartment Types**
- 1B2P\_01
  - 1B2P\_02
  - 2B4P\_02
  - 2B3P\_01
  - 2B3P\_09
  - 2B4P\_04
  - 2B4P\_13
  - 2B4P\_02
  - 3B6P\_02

1. Selected Oat Brick
2. Selected Windows
3. Metal Panels (Colour RAL TBC)
4. Selected Render
5. Ventilated Grills
6. Glass Balcony
7. Powder Coated Metal Balcony
8. Selected Stone
9. Selected Glazing

Revision Number	Date	Drawn	Details of Issue / Revision
Issues & Revisions			



**Client Details:**  
 GEDV Monkstown Owner Limited, 3rd Floor  
 Kilmore House, Park Lane, Spencer Dock,  
 Dublin 1.

**Project Details:**  
 Dalguise  
 Monkstown

**Drawing Title:**  
 Proposed GA Plans - Block F + G - Sheet 02

Job No. <b>P21-066D</b>	Sheet Size: <b>A1_</b>	Scale @A1: <b>1:200</b>
Issue Date: <b>24/10/2022</b>	Drawn By: <b>M.G</b>	Reviewed By: <b>E.O.B</b>

Status	Purpose of Issue	Revision
<b>P01</b>	<b>PLANNIN PERMISSION</b>	
		<b>P02</b>

**MKS-RAU-FG-ZZ-DR-AR-101**