

- NOTES:
1. ALL DIMENSIONS ARE IN MILLIMETRES (mm) UNLESS OTHER NOTED
  2. THIS DRAWING IS TO BE READ IN CONJUNCTION WITH ALL ENGINEERS AND ARCHITECT'S DRAWINGS. FIGURED DIMENSIONS ONLY (NOT SCALING) TO BE USED. WHERE A CONFLICT OF INFORMATION EXISTS OR IF IN ANY DOUBT.
  3. HYDROBRAKES TO BE LOCATED ON THE DOWNSTREAM OF THE ATTENUATION TANKS.
  4. REFER TO STORMWATER DRAWING W3683-DR-1014 FOR SPECIFIC HYDROBRAKE DETAILS.
  5. INSPECT HYDROBRAKE SILT TRAP REGULARLY FOR SILT ACCUMULATION, AND ESTABLISH APPROPRIATE SILT REMOVAL FREQUENCY OF MINIMUM SIX MONTHLY INTERVAL OR AS REQUIRED.
  6. DETAILED DESIGN & SPECIFICATION OF BLUE & GREEN ROOF OR PODIUM SYSTEMS BY THE SUPPLIER, SUBJECT TO APPROVAL.
  7. ALL MEMBRANES/SHEETS TO BE UV STABILISED & ROT PROOF.
  8. A 100mmØ EMERGENCY PARAPET OVERFLOW PIPE SHOULD BE PROVIDED ON ALL BLUE ROOFS.
  9. SEE ESR REPORT FOR MAINTENANCE REQUIREMENTS FOR BLUE/GREEN ROOFS.

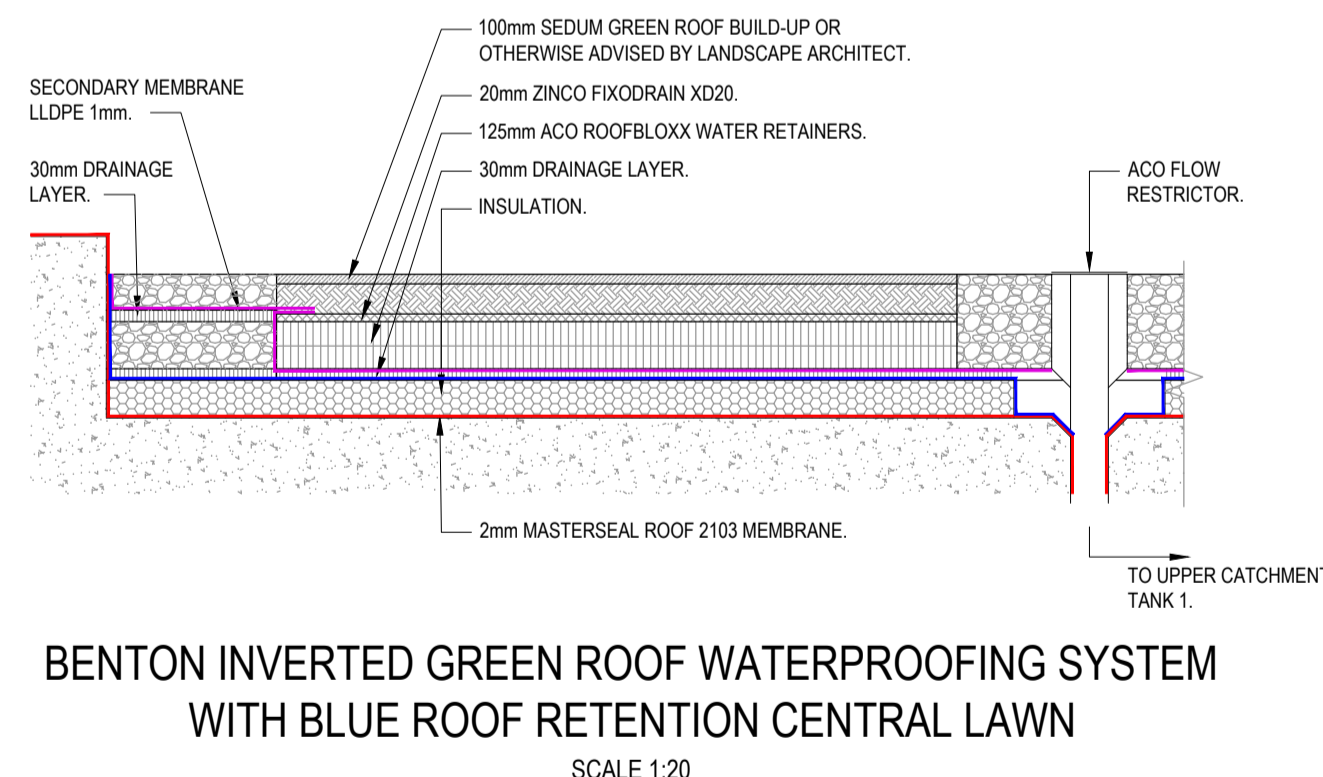
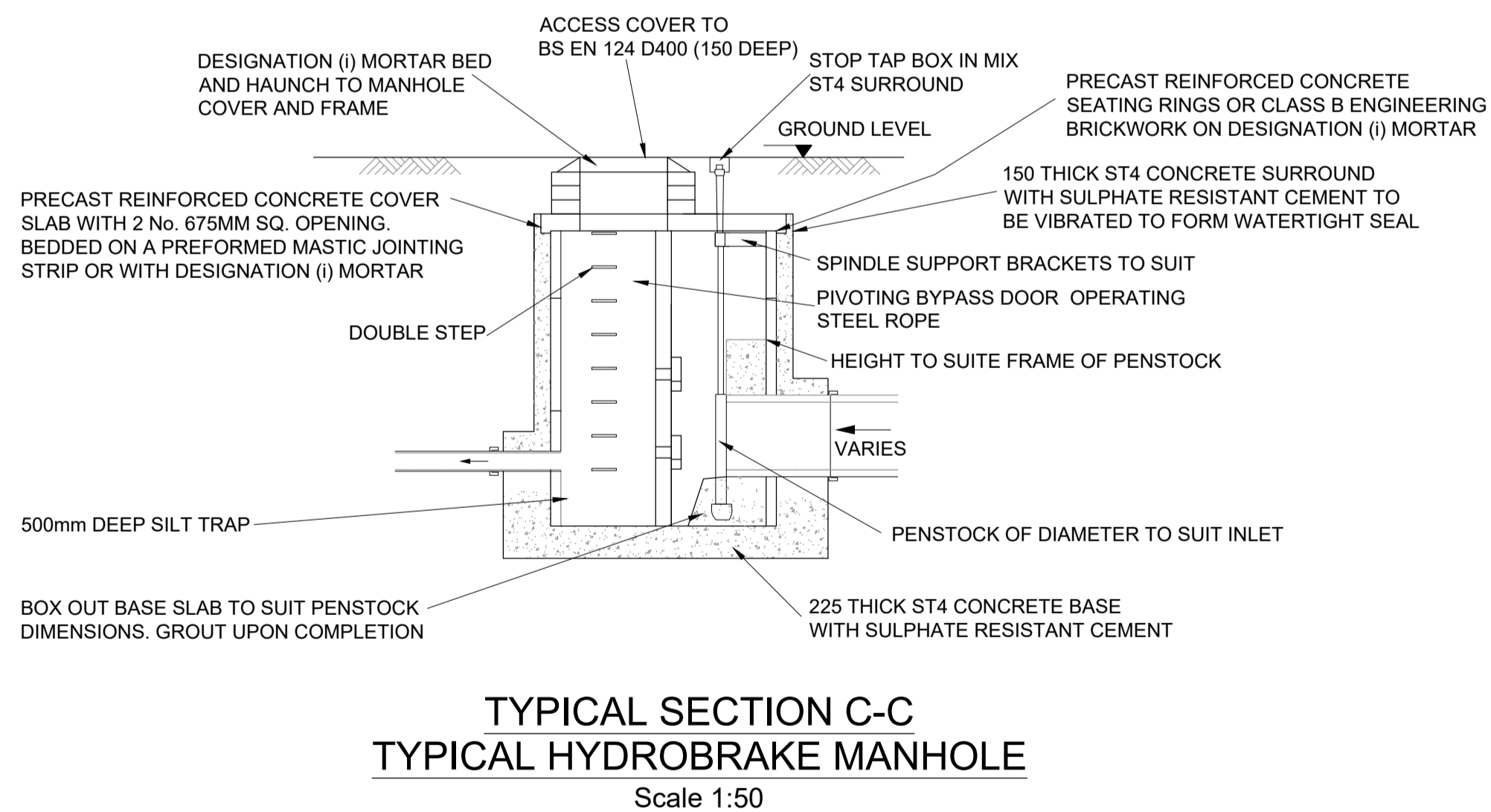

PO	25/10/22	ISSUE FOR PLANNING	LT	RT	AG
Rev	Date	Description	By	Chk	App

**BYRNE LOOBY**  
 WWW.BYRNELOOBY.COM  
 IRELAND | UK | UAE | BAHRAIN | KSA

CLIENT  
 GEDV MONKSTOWN OWNER LIMITED

PROJECT  
 RESIDENTIAL DEVELOPMENT ON LANDS OF DALGUISE HOUSE

DRAWING TITLE  
 STANDARD DETAIL  
 PENSTOCK-HYDROBRAKE MANHOLE & GREEN/BLUE ROOF SYSTEMS

STATUS  
 FOR PLANNING

Date	25/10/22	Scale	AS SHOWN	Drawn	LT	Chk	RT	App	AG
Project No:	W3683	Drg. No:	W3683-DR-1023	Rev:					PO